



The Mt. Pisgah

In 1776, General Griffith Rutherford led an expedition in the mountains of NC. Accompanying this expedition as a chaplain was Rev. James Hall. The men of the expedition saw the mountain from the French Broad River valley and saw a rich land around it -- a land of milk and honey, a promised land. They drew parallel with the land that Moses saw from Pisgah and applied the Biblical appellation to the mountain.

The Mt. Pisgah by MossCreek harkens back to America's rich heritage of living and building off the land. With the use of natural materials of wood, stone, and glass, the Mt Pisgah appears to be "born of the earth," creating the perfect small rustic home.

Copyright 2008 MossCreek

Main Level: 1,280 s.f.
 Upper Level: 646 s.f.
 Total: 1,926 s.f.

**This Plan
 Available for
 Purchase**

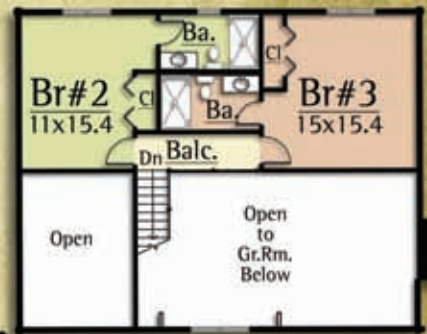

UPPER LEVEL

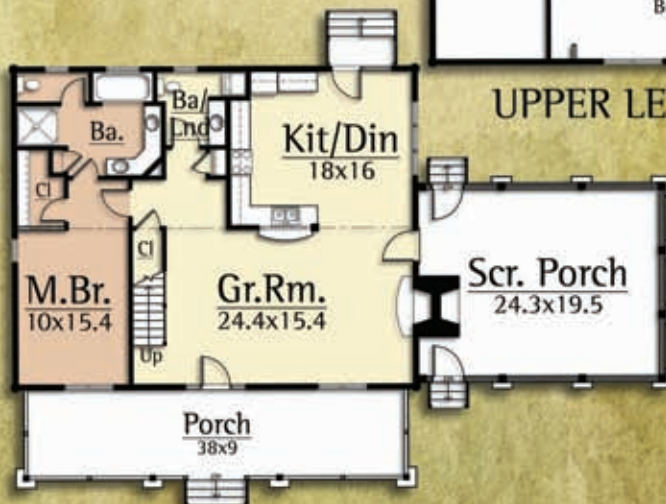

MAIN FLOOR

MOSSCREEK *Luxury Made Simple*

www.MossCreek.net
 800.737.2166

